

MIXPAC™ A-System Overview



50/75mL Industrial Set

ACCESSORIES

Accessories

	ID	Article
	101651	BRT 205-10
	102274	IOT 406-15
	102277	IOT 506-15
	102356	LA 05-00
	102357	LA 06-08

Outlet Tip

-  Tapered Tip (S)
-  Straight Tip (D)
-  Luer Slip Tip (L)
-  Stepped Tip (T)

MIXER



50mL

CARTRIDGE

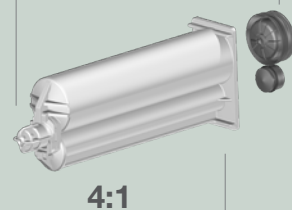
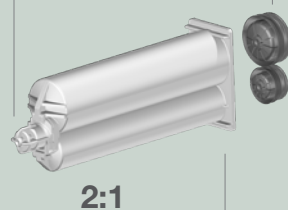
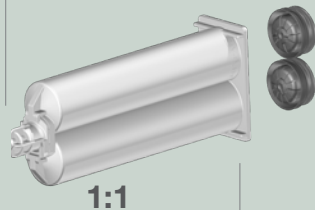

DISPENSER



Piston Retention Plate



Ratio	ID	Article
1:1/2:1	103213	PR 050-01-02 
4:1/10:1	103214	PR 050-04-10 



● MAHX (Helix)

75mL

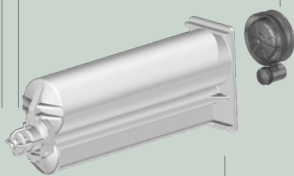

10:1

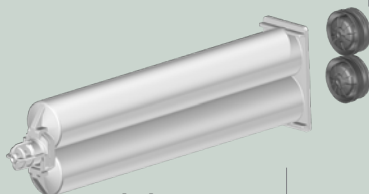

1:1



● DP



MIXPAC™ A-System Cartridge Set

50/75 Industrial Set Cartridge Assembly 50/75mL





Ratio Set/ Volume	ID	Article	Cartridges Material/ Color	Piston Type/ Material	O-ring	Units/ Box	Mixer Technology	Matching Dispenser	
1:1 50mL	110353	AA 050-01-10-01	PP/○	PP, self-venting	-	1250	MAH ○ MAQ ●	DMA ● DP ●	
	112781	AA 050-01-10-02	PP/○	PP, self-venting	EPDM	1250	MAH ○ MAQ ●	DMA ● DP ●	
	110507	AA 050-01-10-03	PP/○	PP	EPDM	1250	MAH ○ MAQ ●	DMA ● DP ●	
	116606	AA 050-01-10-05	PP/●	HDPE, solid piston	EPDM	1250	MAH ○ MAQ ●	DMA ● DP ●	
	116878	AA 050-01-10-06	PP/○	A-piston self-venting lip seal piston PA with EPDM O-ring, B-Piston self-venting lip, seal piston PP	EPDM	1250	MAH ○ MAQ ●	DMA ● DP ●	
	154840	AA 050-01-10-33	PP/○	HDPE, self-venting	-	1250	MAH ○ MAQ ●	DMA ● DP ●	
	154826	AA 050-01-10-34	PP/○	HDPE, self-venting	EPDM	1250	MAH ○ MAQ ●	DMA ● DP ●	
	116221	AA 050-01-30-01	PA/○	PA, self-venting	-	1250	MAH ○ MAQ ●	DMA ● DP ●	
	116415	AA 050-01-30-02	PA/○	PA, self-venting	EPDM	1250	MAH ○ MAQ ●	DMA ● DP ●	
	154841	AA 050-01-30-33	PA/○	HDPE, self-venting	-	1250	MAH ○ MAQ ●	DMA ● DP ●	
	154852	AA 050-01-30-37	PA/●	HDPE, self-venting	-	1250	MAH ○ MAQ ●	DMA ● DP ●	
	1:1 75mL	116107	AA 075-01-10-01	PP/○	PP, self-venting	-	625	MAH ○ MAQ ●	DMA ● DP ●
		116420	AA 075-01-10-02	PP/○	HDPE, solid piston	EPDM	625	MAH ○ MAQ ●	DMA ● DP ●
		154874	AA 075-01-10-33	PP/○	HDPE, self-venting	-	625	MAH ○ MAQ ●	DMA ● DP ●
154876		AA 075-01-10-34	PP/○	HDPE, self-venting	EPDM	625	MAH ○ MAQ ●	DMA ● DP ●	
2:1 50mL		111201	AA 050-02-10-01	PP/○	PP, self-venting	-	1250	MAH ○ MAQ ●	DMA ● DP ●
	111374	AA 050-02-10-03	PP/○	HDPE, solid piston	EPDM	1250	MAH ○ MAQ ●	DMA ● DP ●	
	116416	AA 050-02-30-01	PA/Ⓝ	PA, self-venting	-	1250	MAH ○ MAQ ●	DMA ● DP ●	
	154690	AA 050-02-10-33	PP/○	HDPE, self-venting	-	1250	MAH ○ MAQ ●	DMA ● DP ●	
	154644	AA 050-02-10-34	PP/○	HDPE, self-venting	EPDM	1250	MAH ○ MAQ ●	DMA ● DP ●	
	154691	AA 050-02-30-33	PA/○	HDPE, self-venting	-	1250	MAH ○ MAQ ●	DMA ● DP ●	
	4:1 50mL	116417	AA 050-04-10-01	PP/○	A-piston, PA, self-venting lip seal; B-piston, HDPE, solid piston with O-ring	EPDM	1250	MAHX ● MAQ ●	DMA ● DP ●
116676		AA 050-04-10-03	PP/○	HDPE, solid piston	EPDM	1250	MAHX ● MAQ ●	DMA ● DP ●	
116877		AA 050-04-30-02	PA/Ⓝ	A-piston, PA, self-venting lip seal; B-piston, PA, solid piston with O-ring	EPDM	1250	MAHX ● MAQ ●	DMA ● DP ●	
10:1 50mL	116418	AA 050-10-10-01	PP/○	A-piston, PP, self-venting lip seal; B-piston, HDPE, solid piston with O-ring	-	1250	MAHX ● MAQ ●	DMA ● DP ●	
	116419	AA 050-10-30-01	PA/Ⓝ	A-piston, PA, self-venting lip seal; B-piston, PA, solid piston with O-ring	-	1250	MAHX ● MAQ ●	DMA ● DP ●	
	116675	AA 050-10-10-02	PP/○	HDPE, solid piston	EPDM	1250	MAHX ● MAQ ●	DMA ● DP ●	
	116917	AA 050-10-10-03	PP/○	A-piston, PP, self-venting lip seal; B-piston, HDPE, solid piston with O-ring	EPDM	1250	MAHX ● MAQ ●	DMA ● DP ●	
	128166	AA 050-10-20-03	PBT/Ⓝ	A-piston, PA, self-venting lip seal; B-piston, PA, solid piston with O-ring	-	1250	MAHX ● MAQ ●	DMA ● DP ●	
	116915	AA 050-10-30-02	PA/○	A-piston, PA, self-venting lip seal; B-piston, PA, solid piston with O-ring	EPDM	1250	MAHX ● MAQ ●	DMA ● DP ●	

Matching mixers

	ID	Article	Number of Elements	Inner Diameter Ø mm/inch	Waste Volume (mL)	Units/Box	Outlet Tip				Accessories						
							Stepped Tip (T)	Straight Tip (D)	Luer Slip Tip (L)	Tapered Tip (S)	BRT 205-10	IOT 406-15	IOT 506-15	LA 05-00	LA 06-08		
1:1/2:1 MAH 	102361	MAH 03-07S	7	3.0/0.118	0.24	15000			✓								
	102362	MAH 03-13S	13	3.0/0.118	0.36	12000			✓								
	102364	MAH 03-17S	17	3.0/0.118	0.34	10000			✓								
	102366	MAH 04-13S	13	4.0/0.157	0.60	10000			✓								
	102367	MAH 04-17D	17	4.0/0.157	0.75	7000	✓				✓						
	102368	MAH 04-17S	17	4.0/0.157	0.75	7500			✓								
	102369	MAH 05-07T	7	5.4/0.213	0.80	10000	✓							✓			
	102370	MAH 05-13D	13	5.4/0.213	1.36	7000		✓			✓		✓				
	102371	MAH 05-13T	13	5.4/0.213	1.36	6500	✓							✓			
	102360	MAH 0517-0413T	17 +13	5.4/0.213 4.0/0.157	2.07	4000	✓										
	102372	MAH 05-17T	17	5.4/0.213	1.68	4000	✓								✓		
	102373	MAH 05-21T	21	5.4/0.213	2.01	3000	✓								✓		
	102377	MAH 06-12T	12	6.3/0.248	2.08	4500	✓										✓
	102378	MAH 06-17T	17	6.3/0.248	2.94	3000	✓										✓
	102379	MAH 06-21L	21	6.3/0.248	3.33	4000			✓								
102380	MAH 06-21T	21	6.3/0.248	3.57	2500	✓										✓	
4:1/10:1 MAHX 	102535	MAHX 04-17S	17	4.0/0.157	0.75	7500			✓								
	102536	MAHX 05-17T	17	5.4/0.213	1.68	4000	✓							✓			
1:1/2:1/4:1/10:1 MAQ  Color	300028	MAQ 05-16L	16	5.3/0.209	1.30	5000			✓								
	300026	MAQ 05-24L	24	5.3/0.209	1.90	3000			✓								
	300391	MAQ 05-16L-12 ●*	16	5.3/0.209	1.30	5000			✓								
	300405	MAQ 05-16L-13 ●*	16	5.3/0.209	1.30	5000			✓								

* different color

Matching dispensers

	ID	Article	Flange		Ratio				Force (kN)
			A		1:1	2:1	4:1	10:1	
DMA dispenser manual 	101875	DMA 51-00-10	✓		✓	✓			1.2
	101883	DMA 54-00-10	✓		✓	✓	✓		1.2
	112790	DMA 59-00-10	✓		✓	✓		✓	1.2
	111746	DMA 75-00-10	✓		✓				1.2
DP dispenser pneumatic 	151780	DP2 50-16-100	✓		✓	✓	✓	✓	1.6
	153098	DP2 75-16-100	✓		✓				1.6